



Recommendations

Prepared for
FAST BLOOMS TO BEES CLIENT

CONCEPT

The new front planting scheme will take a modern approach to classic New England style using whites and purples. Traditional hydrangea and lavender are paired with native flowering plants like hyssop, baptisia, aster, and amsonia that offer different takes on blue and purple flowers and introduce new foliage textures. Two native evergreens, juniper and inkberry, add color to the long winters. A native flowering dogwood balances the architecture of the house and provides spring interest.



LANDSCAPING

Establishing the Bed

Connect the planting bed along the fence to the foundation bed in front of the house with a curved line, removing the grass near the gate. Then sweep the line to the driveway, creating a new bed in front of the sidewalk. Unifying these beds will simplify the look.

De-emphasize the mailbox and the lamp post by eliminating the planting bed and filling in the area with grass. If the tan fence is yours, consider painting it to match the gate.

For a modern look, try plastic edging that is flush with the ground level or consider a CorTen steel edging product with a natural patina or a sprayed dark coating. If you'd like to reuse your existing Belgian block stone edging but don't have enough, try sourcing it from Craigslist or local Freecycle groups.



Example of Belgian block used as edging.

PLANTS

Create Balance with Shrubs and a Tree

To enhance symmetry, draw attention to the front door with a pair of narrow evergreen juniper shrubs. Consider the native *Juniperus scopulorum* 'Blue Arrow,' which is only two feet wide and grows to a maximum height of 12-15 feet (it can be pruned shorter). Other native cultivars are equally narrow—look for either *Juniperus scopulorum* or *virginiana* on the plant tag to make sure you are buying native.

To the right of the door, add a hydrangea next to the juniper. You can relocate a hydrangea from somewhere else on your property or plant a new one. If buying, *Hydrangea arborescens* comes in many cultivars. 'Lime Rickey' is a white green, 'Incrediball' is white, and there are also pinks. If possible, match the color to the hydrangea to the left of the door.

Along the fence, add evergreen *Ilex glabra* dwarf cultivars such as 'Compacta' or 'Shamrock' between the hydrangea to provide winter interest.

Lastly, a spring-flowering ornamental tree, such as a pink flowering dogwood, could add additional interest and balance to your yard. Consider siting it to the right of the house. The spring flowers feed emerging beneficial insects and its fruit will feed birds. It also has a lovely fall color.

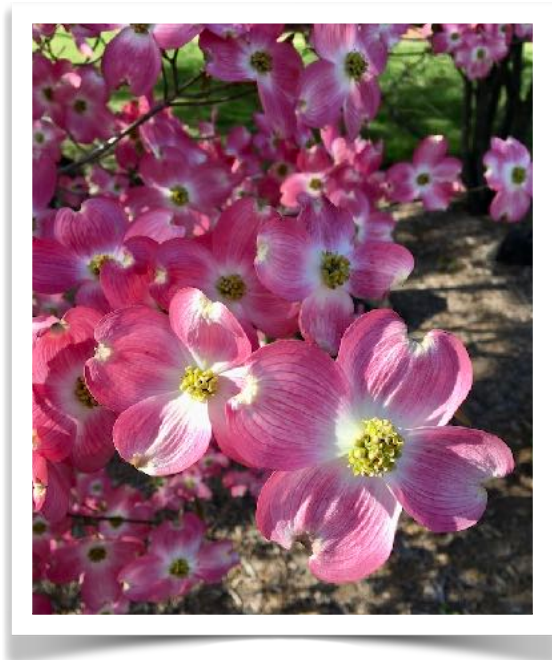

CORNUS FLORIDA

Flowering Dogwood

Sunlight

Full sun, part sun, part shade

Supports

Pollinators, butterflies, birds

Notes: Look for *Cornus florida* 'Cherokee Chief' and *Cornus florida* 'Comco No. 1' (sold under the trade name Cherokee Brave). Pink spring flowers, good fall color.

Occasionally seriously damaged by deer.

Full listing of shrubs and trees intentionally skipped for brevity —————

Perennial Selections

Lavender is used in a mass planting along the sidewalk for maximum effect. The rest of the plants continue the purple color theme and give additional interest through foliage variation.



AMSONIA HUBRECTII

Arkansas Blue Star

Sunlight

Full sun, part sun

Supports

Pollinators

Notes: Flowers very early when few other things are in bloom, and its fall color is bright yellow. During the summer, the delicate thread leaf foliage adds great texture.

Seldom seriously damaged by deer.

Full listing of perennials intentionally skipped for brevity —————

Plant List and Bloom Schedule

Plant	Height	Spread	Flower	May	Jun	Jul	Aug	Sept	Oct	Nov
Arkansas Blue Star (<i>Amsonia hubrechtii</i>)	3-4	3-4	Blue	X	X					
Blue False Indigo (<i>Baptisia australis</i>)	3-4	3-4	Blue	X	X					
New England Aster 'Purple Dome' or 'Raydon's Favorite' (<i>Symphotrichum novae-angliae</i>)	2-3	2-3	Purple					X	X	X
Hyssop 'Blue Boa' (<i>Agastache</i>)	2-3	1-2	Purple		X	X	X			
Lavender (<i>Lavendula x intermedia</i>)	2-3	2-3	Blue		X	X	X			
Pink Flowering Dogwood (<i>Cornus florida</i>)	15-25	15-25	Pink	X						
Inkberry 'Compacta' (<i>Ilex glabra</i>)			Green							
Juniper 'Blue Arrow'	12-15	2-3	Green							
Smooth Hydrangea (<i>Hydrangea arborescens</i>)	3-4	3-4	White			X	X			

PLAN VIEW

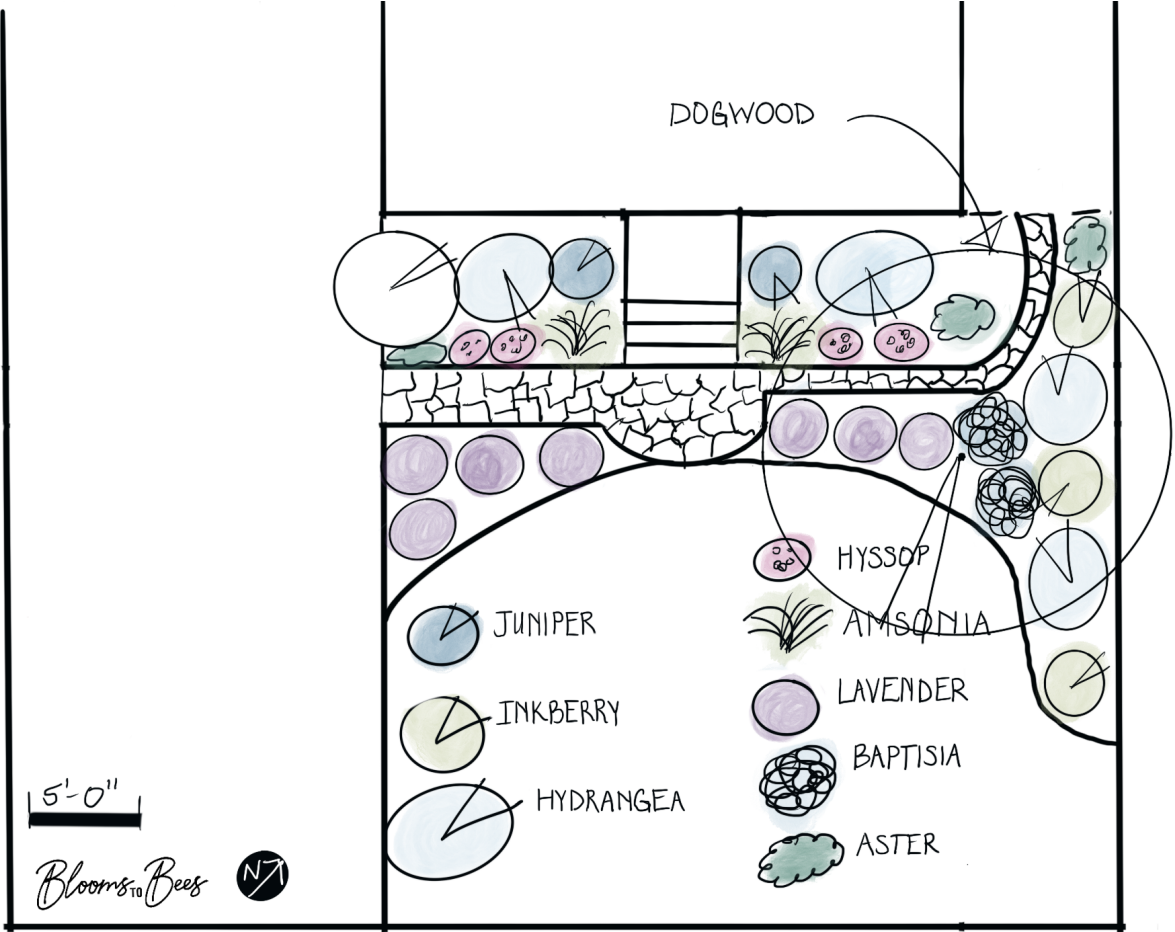

YOUR NEW GARDEN

Plans include personalized recommendations for:

- Purchasing native plants online or locally
- Preparing the planting site
- Establishing native plants so they self-sustain
- Protecting new plantings from (unwanted) wildlife

*Enjoy your
planet-friendly garden!*